

# TRAN-E-CSB-D

Technical Datasheet for DALI Controller

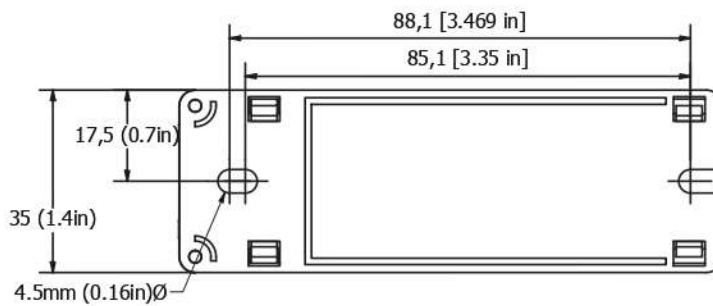

## Description



## Technical Specifications

### Mechanical

Housing	Black Plastic Injection Moulded ABS
Dimensions	103mm x 35mm x 28mm
Weight	52g
Protection	IP20
Mounting	Screwdown

### Input

Voltage Range	120-277VAC
Frequency	50-60Hz
Max Mains Current	20mA
No-load Standby Power	<500mW (No loads on DALI bus)

### DALI Output

Voltage Range	16VDC @ 16mA Max
Max. drivers	8

### Radio Transceiver

Operating Frequencies	2.4Ghz - 2.483Ghz
Maximum Output Power	+4dBm
Wireless Protocol	Casambi Wireless Mesh

### Operating Conditions

Ambient Temperature	0°C to +50°C
Max. Case Temperature	+75°C
Storage Temperature	-40°C to +80°C
Max. Relative Humidity	80% non-condensing

### Connectors

Wire Range	0.2mm - 1.5mm
Wire Strip Length	5mm

## Dimensions

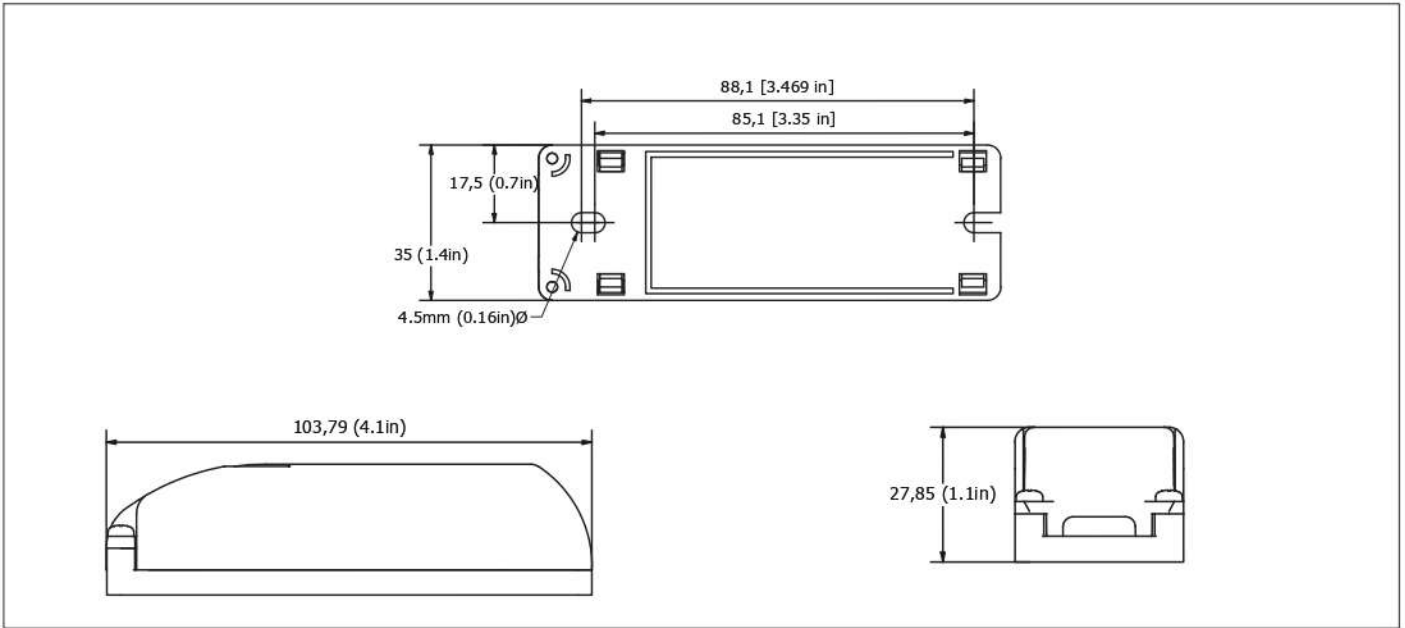

## Wiring Diagram

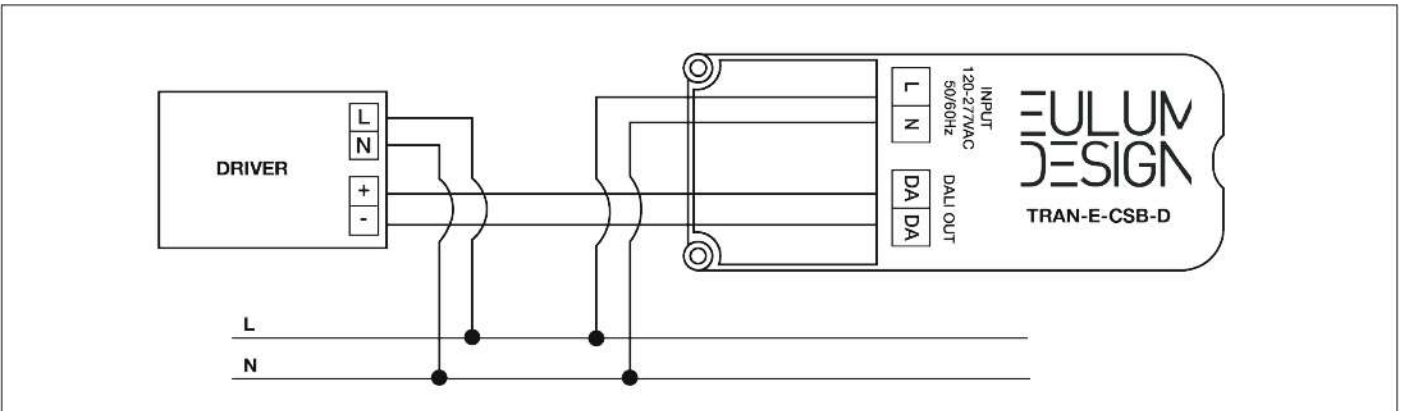

## Profiles

Profile Name	Description
TRAN-E-CBDA-1	Broadcast, single colour
TRAN-E-CBDA-4	4 address-auto, independent channels
TRAN-E-CBDA-RGB	3 address-auto, RGB
TRAN-E-CBDA-RGBW	3 address-auto, RGB
TRAN-E-CBDA-TW	2 address-auto, tunable
Version	Evolution

## Calibration

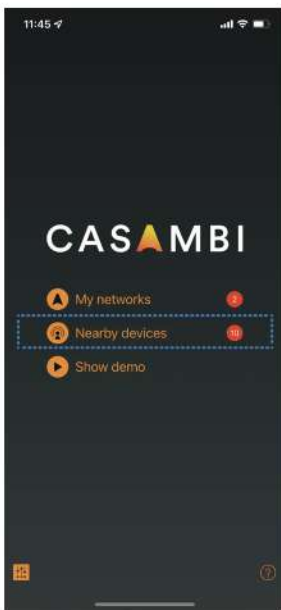

1. Power on the device and open the Casambi App, select “Nearby devices”.



2. Tap “Nearby Devices”



2. Tap the TRAN-D and then “Change profile”.

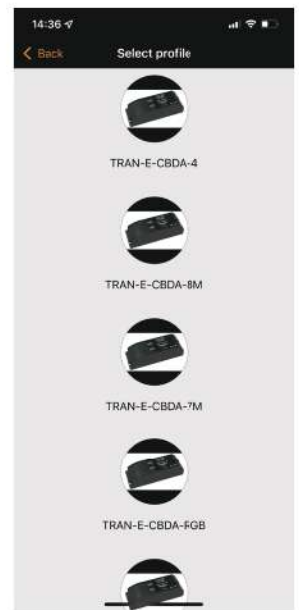

4. Choose your desired profile. TRAN-E-CBDA-1 is the standard profile and will not show.

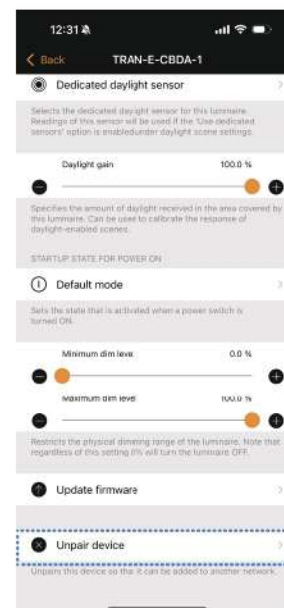

NOTE: The TRAN must be unpaired to change the profile. To unpair, double tap the TRAN-E-CBDA-1 in the network and scroll to the bottom of the options to “Unpair Device”, then follow step on from Step 1 above.

## Range

In open air, the wireless range can reach up to 75m. This will be reduced when placed inside a building. Please note that putting the unit inside a metal enclosure is unadvised as this will dramatically reduce the signal range.

## Compatible Devices:

iPhone iOS and later are supported

iPad iOS 10 and later are supported

Android 4.4 version (KitKat) and later are supported.

